



UK Owners Manual

**Please read before riding and
keep safe for future reference.**

Contents

3	Contents / Welcome
4	Getting to know your Kansi
4-5	Parts listing / diagram
6-9	Getting started
10	The hinge levers explained
11	How the hinge lever works
12-13	Fold guidelines
14-17	Stay-fold fitting guide
18-23	Rider safety information
24-25	Maintenance guide
27	Kansi settings
28-29	Warranty info
31	Contact info

Welcome

This manual is your guide to keeping your Kansi on the road and running smoothly. Everything you need should be in this guide, however if you have any further questions please contact your local authorised Kansi dealer.

Boring but Important.....

Your Kansi is safe when it is assembled, used and maintained in accordance with the instructions in this manual. Please take the time to read through the manual to ensure you are familiar with how your Kansi works; incorrect assembly, incorrect unfolding or inappropriate use could result in serious injury and we don't want that to happen!

This manual also assumes some knowledge of bicycles and an understanding that regular maintenance is essential to ensure the safe and continued performance of your Kansi. If you are not experienced in owning or riding a bicycle, always consult an authorised Kansi dealer with any questions you may have.

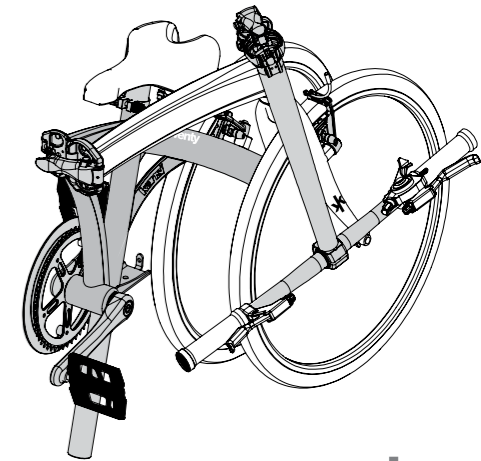

Getting to Know your Kansi

The following page is a simple guide to the different parts of your Kansi.
(Please note that bicycles may vary in colour and have additional parts such as pannier racks, lights and mudguards).

We like to use the following terms when referencing parts for upgrades or spares.

Some of this language can be abbreviated or changed so don't be put off if someone refers to a part differently.

Frame serial numbers are generally stamped on the underside of the bottom bracket shell, the part of the frame that the chainset runs through. It's a good idea to keep a record of this number. We like to keep ours inside our Kansi passport, please ask your Kansi dealer for yours if they haven't already provided this.

All spares are available through the Kansi dealer network.
Find your nearest kansi dealer at www.kansi.co.uk

Parts

- A Frame
- B Fork
- C Hub
- D Spoke
- E Rim
- F Tyre
- G Pedal
- H Bottom bracket / Frame No.
- I Cranks/ Chainset
- J Chain
- K Cassette / Rear sprocket
- L Rear derailleur
- M Replaceable mech hanger
- N Rear brake
- O Kansi model name
- P Seat post clamp
- Q Seat post
- R Seat clamp
- S Kansi saddle
- T Frame hinge lever
- U Handlebar post
- V Handlebar
- W Brake lever
- X Shift lever (if applicable)
- Y Handlebar post lever
- Z Front brake

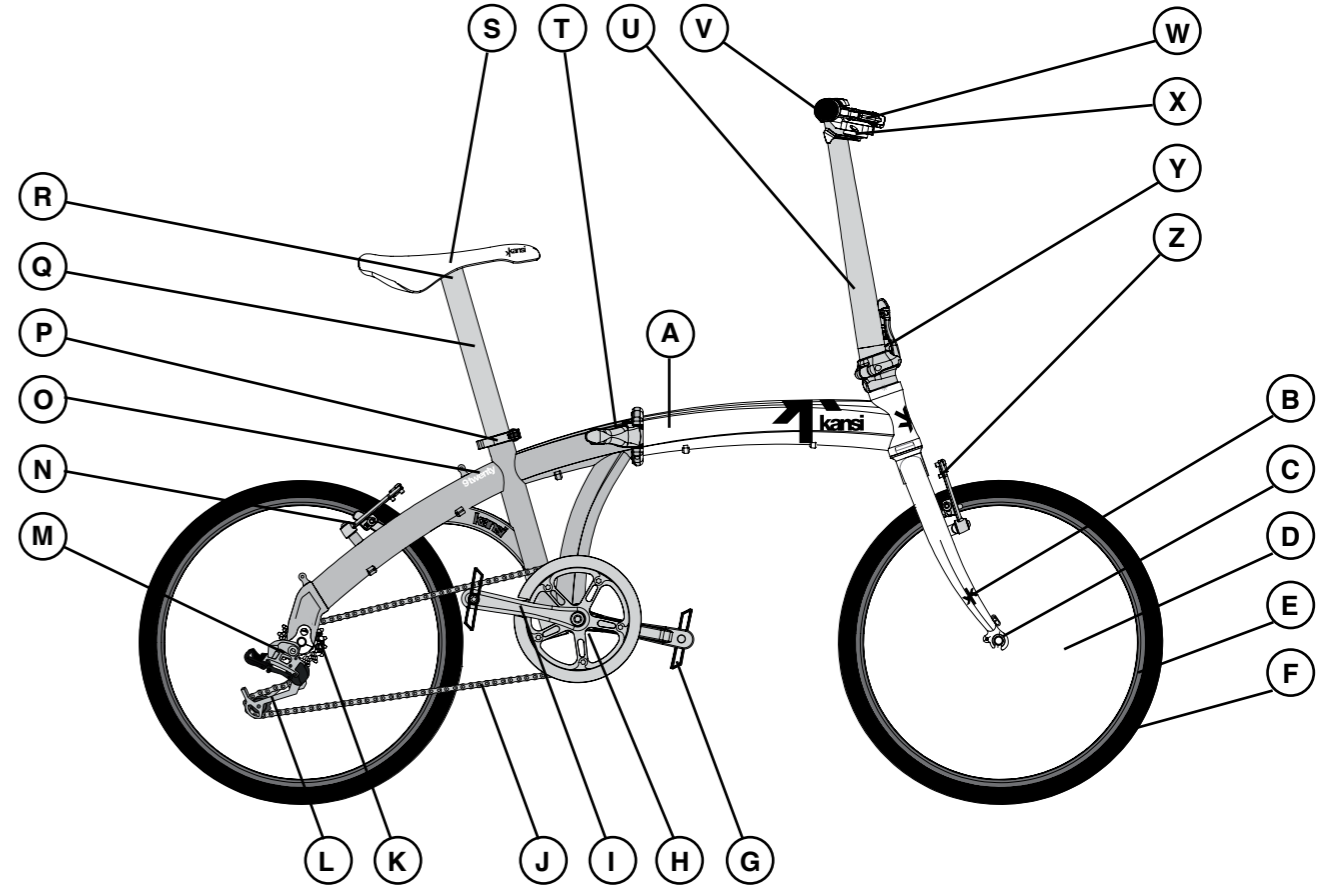

Getting Started

All folding bicycles and mini-bikes are intended for use on paved roads only. Make sure your bicycle is used for its intended purpose as misuse may lead to the failure of a component or part.

Tools Required

To assemble your Kanshi, a suitable 15mm open ended spanner is required to securely tighten the wheel axle nuts and attach the pedals to the cranks (please refer to page 8).

Saddle Height

Adjustment of the saddle height on your Kanshi is quick and simple, as the seat post clamp is operated by a quick release mechanism. The best and correct riding position is one which gives you the greatest comfort, combined with maximum pedalling efficiency. A correctly set up bicycle should be a pleasure to ride. A badly set up one can be very uncomfortable. As a general guide, when riding normally with the balls of your feet on the pedals, your knees should be slightly bent at the bottom of the pedal stroke.

IMPORTANT: Towards the lower end of the seat post there is a Minimum Insertion mark. It is essential that when the height of the saddle is initially set, and on any subsequent adjustments, the Minimum Insertion mark is kept below the top of the seat tube. It must not be visible.

To make your Kanshi easier to carry when folded, the seat post can be lowered so that it protrudes from the base of the seat tube. Your Kanshi MUST NOT be ridden with any part of the seat post protruding from the lower end of the seat tube. This means the minimum saddle height of your Kanshi, when measured from the ground to the top of the saddle, is approximately 87cm (34 ins).

Saddle Position

Your Kanshi saddle can be adjusted forward or backward to help you get the best possible position on the bike. Ask your dealer to help with the saddle adjustment as they will be able to advise you on how to gaining the optimal riding position. Most people prefer a horizontal saddle, but that said we know we are all different shapes and sizes, so don't be afraid to find your own comfort through adjustment.

WARNING: After any saddle adjustment, be sure that your Kanshi saddle mechanism is properly tightened before riding. A loose saddle clamp or seat post clamp can cause damage to the seat post and may even lead to loss of control. There should be no movement or play in your Kanshi seat post or saddle, so from time to time please check to make sure. This is a contact point so does require attention occasionally.

Wheel Condition

Ensure that the rims on your Kanshi are clean and undamaged along the braking surface. Check for excess rim wear, dents, dings or any other damage. Wear does take place on rims and the alloy rims of your Kanshi have a rim wear groove built into their braking surface. Should any part or section of the indicator line disappear the wheel must be replaced. Riding a bicycle with a wheel rim that is excessively worn is dangerous, the wheel could suddenly fail. Keeping your Kanshi clean and well maintained can significantly reduce the likelihood of needing to do this. Likewise, your wheels support you and your Kanshi everywhere you go. We advise you to periodically check the wheel spoke tensions, as spotting loose or damage spokes early, can prevent wheels from becoming bent or buckled. We suggest using your local Kanshi dealer for any wheel adjustments that may need to be made.

Getting Started (continued)

Handlebar Set Up

Make sure that your Kanshi handlebar grips are secure and in good condition. Poor or worn grips can affect the pleasure of riding your Kanshi. Make sure your Kanshi locking clamps are always tight, as this will avoid any rotation in the grip. Failure to do so could lead to loss of control and an uncomfortable ride.

Quick Release Mechanisms

Your Kanshi is fitted with a quick release seat post clamp and depending on the model you have, it may also have quick release wheels. For your safety, it is essential that the quick release levers are securely fastened.

The best way to firmly close a lever is to use both the palm and fingers of one hand. With the lever resting on your palm and your fingers either around the seat post and clamp or behind the left hand fork blade (depending on which mechanism is being closed) squeeze the lever shut. The pressure to do this should leave an imprint on your palm that disappears within 5 to 10 seconds. If you cannot see an imprint of the lever, the mechanism is not tight enough. With quick release wheel mechanisms, in technical terms, 'the lever should emboss the fork ends when closed to the locked position.'

Pedals

Whilst your Kanshi will have been fully assembled by the dealer, we know there may be some customers who ask for the pedals not to be attached when collecting their bicycle. It is essential that when pedals are fitted, their axles are fully tightened into the cranks.

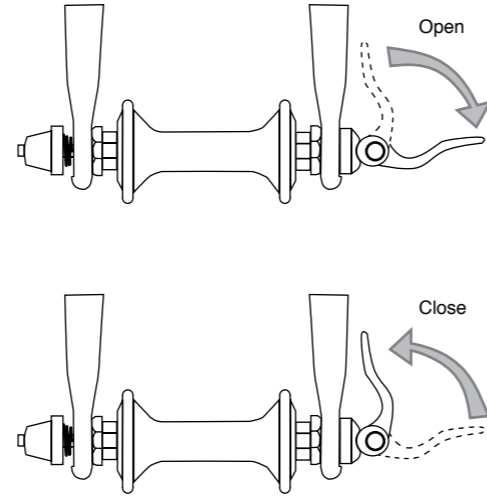

Before attaching the pedals, identify which is the left and which is the right. The ends of their threaded axles will either be stamped with L (left) or R (right). Whilst they may look identical, the right has a normal thread and screws in clockwise, but the left has a left handed thread and screws in anticlockwise. Screw the right pedal into the crank that is on the chain side of your bicycle, in a clockwise direction. Initially, this should be done by hand to make sure it is not cross threaded, and then tightened very firmly with a 15mm open ended spanner. Repeat this procedure with the left hand pedal but screw it in an anticlockwise direction.

Brake Set Up and Stopping Distances

In the UK, Japan and some other parts of the world, the right brake lever operates the front brake, whilst the left lever controls the rear brake (your Kanshi is set up to UK specifications). Prior to each ride, both brakes should be checked to ensure they work efficiently. If you choose to ride under conditions of poor visibility or adverse weather conditions, we suggest you double check the operation of your brakes prior to setting off. Likewise, poor visibility and riding at night require good lighting, so take time to consider your route. When riding on a public road at night in the UK, your bicycle must be equipped with a white front light, a red rear light and a set of reflectors. Stick to roads you know are safe and if possible, well lit. At Kanshi, while we actively encourage riding as much as possible, we are aware that riding in conditions like snow and ice are not always suitable.

In wet conditions, stopping distances and the ability to stop are affected just like when driving a car or motorbike. The same applies when riding your Kanshi, so always ensure this is taken into account when riding in the wet. When it is raining, pay closer attention to the area just in front of your wheel, as this will allow you to make better braking decisions. Potholes and manhole covers pose even greater dangers in the wet, so think ahead and brake earlier than you would normally. Testing the brakes on your Kanshi (for heavy or sharp braking) before starting your ride, is always advisable.

The hinge levers explained

The hinges on Kansi bikes are designed to be ergonomic, functional and offer superior levels of security.

After opening the hinge, there is a hexagonal two-way adjusting screw which has a floating locking nut. The pressure needed to close the hinge lever can be adjusted. Exposing more thread and making the hexagonal screw longer will make the lever feel firmer. Shortening, will make the lever easier to close and lighter in the hand. For safety we recommend the lever operation is as firm as possible.

When making adjustments it is important that the locking nut is checked regularly, likewise it is equally important to check the blue thread locking compound remains effective by securing the locking nut (see step 3) in place. If this is removed or damaged without replacement it could lead to adverse hinge wear and a noisy ride. Remember the hinge is a moving part and just like all moving parts, does need attention from time to time.

We do also advise that adjustments are made bit by bit. If making adjustments yourself, please work on half turns at a time, this way it's easier to work back if adjustments are not right. If in doubt, please contact your local bike dealer, as they will be able to advise and help make any adjustments.

Before riding, always check the anodized button on each hinge is secure and raised proud from its recess in the lever. Check this once again by trying to pull the lever away from the locked position, as this will ensure the button is locked into place.

Please ensure both levers (frame hinge & handlebar post) are locked and secure prior to setting off on any journey. Failure to do so could result in failure or premature wear of parts.

How the hinge lever works

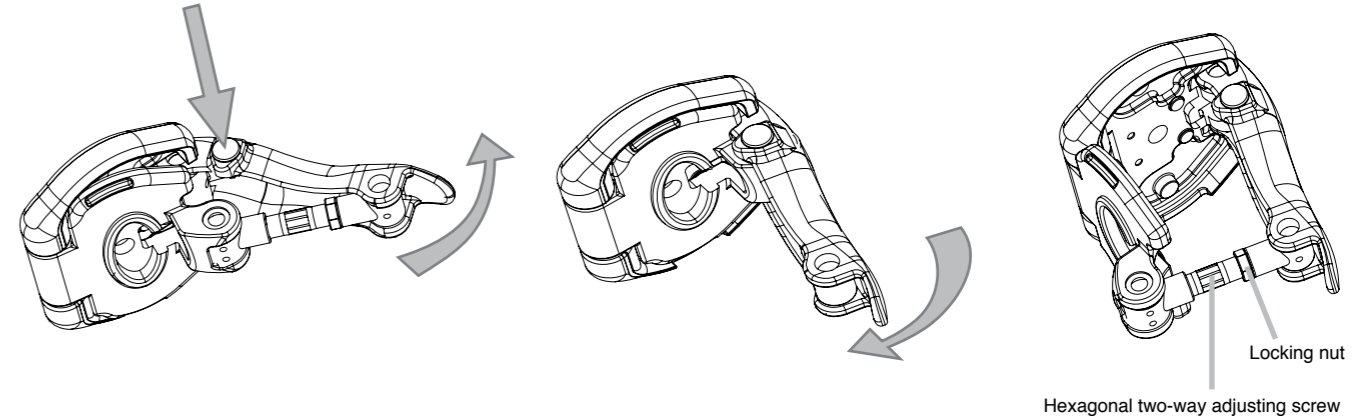

1 Opening

Press button and pull hinge lever simultaneously

2 Closing

Gently push hinge lever toward frame until the button clicks into place

3 Adjusting the hinge

Turn the hexagonal adjusting screw to increase or decrease shaft length and secure using locking nut

Fold guidelines

The simple fold technique of the Kansi can be completed in 5 easy steps. To unfold, simply work your way back through the steps, ensuring all clamps and levers are securely locked in place before riding. Remember to keep your fingers away from the inside of the hinge when folding or unfolding to avoid them getting trapped!

A demonstration of the best way to fold your kansi is also available on www.kansi.co.uk

Folding



1 Preparation

Stand to the left hand side of the bike (non driveside).



2 Lower the seat post

Release the quick release lever and lower the seatpost. Close the quick release lever to lock seatpost in place.

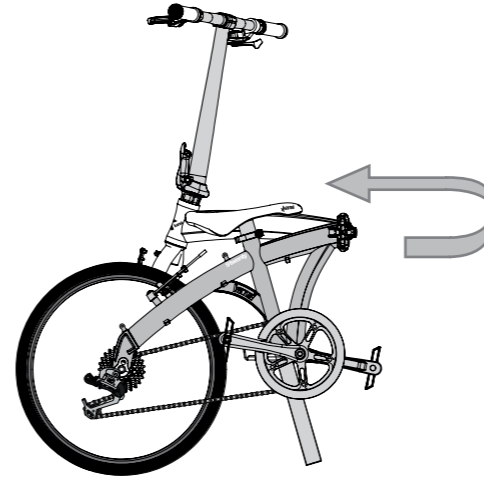

3 Release frame hinge lever and fold frame

Press anodized button and pull hinge lever simultaneously. Lift and fold bike.

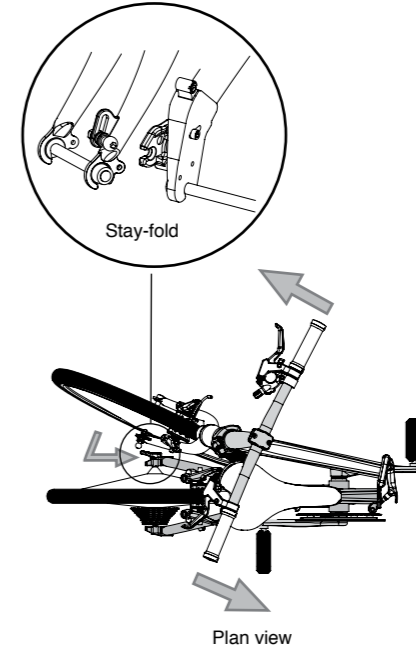

4 Secure using stay-fold system

Align stay-fold catch and turn handlebars anti-clockwise to engage. We advise you carry your Kansi by the frame

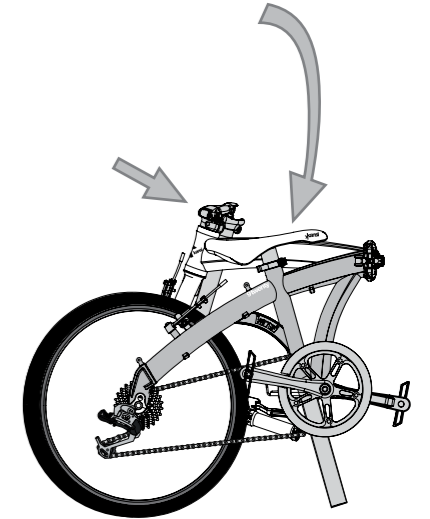

5 Fold handlebar post

Release handlebar post lever and fold.



Kansi stay-fold fitting guide

The Kansi stay-fold has been designed to make sure your Kansi doesn't swing open whilst carrying your bike. This may have already been assembled by your Kansi dealer, but if not, here are a few simple steps to ensure your bike is set up correctly.

Front assembly

Your Kansi will come with the following parts that need to be fitted to the front fork by your authorised kansi dealer.

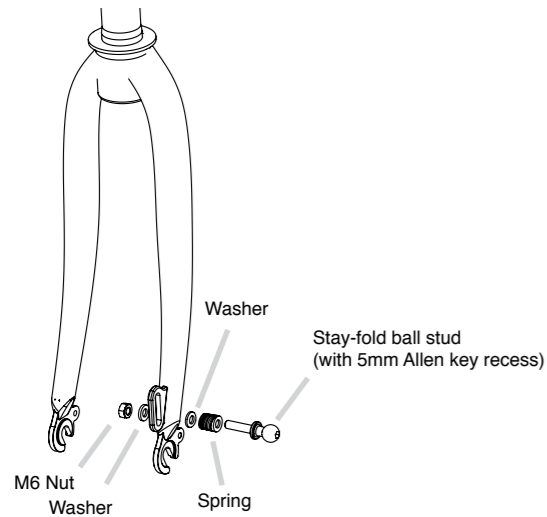

9twenty Rear stay-fold assembly

If you have a Kansi 9twenty your rear stay-fold catch will look like the image below and contain the following parts that need to be assembled on to the non driveside frame dropout.

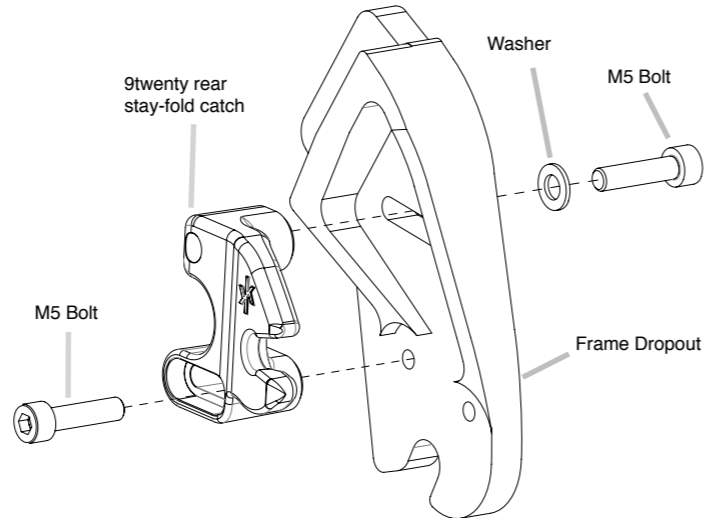

1twenty and 3twenty Rear stay-fold assembly

If you have a Kansi 1twenty or 3twenty your stay-fold catch will look like the image below and contain the following parts for assembly to the non driveside frame dropout.

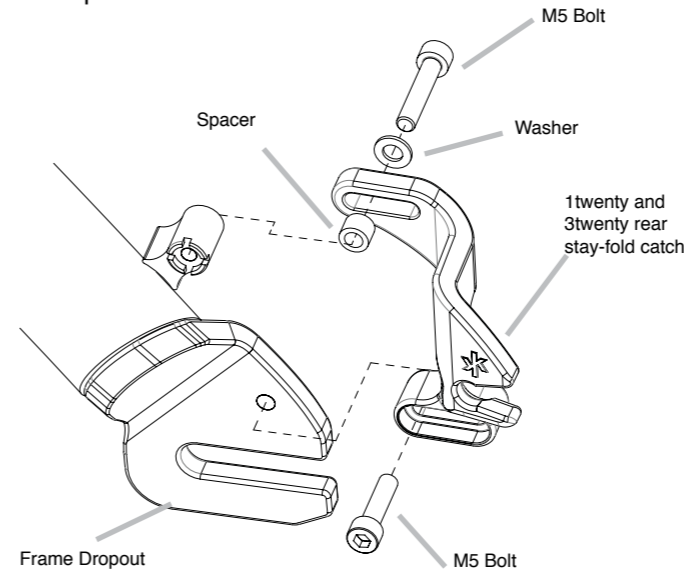

Stay-fold alignment

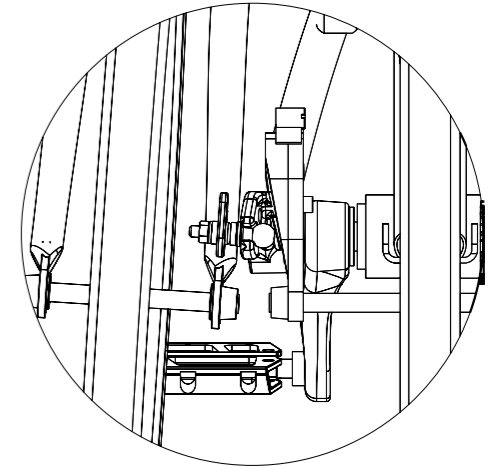

Aligned and locked in stay-fold

Loosely fit the stay-fold parts to make them easy to align before tightening the bolts. Then ensure the stay-fold bolts are securely tightened before riding.

Kansi stay-fold fitting guide (continued)

Stay-fold Adjustment

The stay-fold ball stud needs to be set vertically in-line with the rear stay-fold catch. To adjust the front stay-fold ball stud, simply loosen the ball stud with a 5mm Allen key and a 10mm spanner. Slide the front stay-fold assembly to be vertically parallel with the rear stay-fold catch. Then securely retighten the stay-fold assembly.

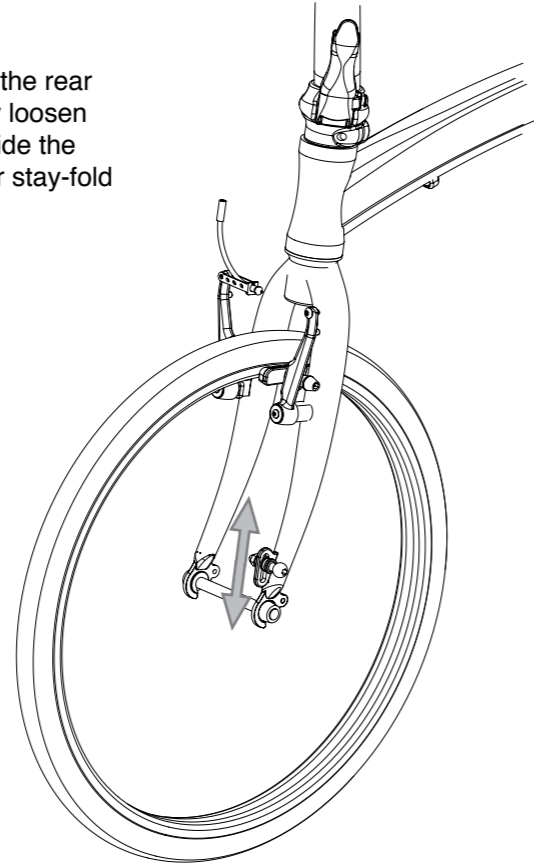

The stay-fold is most effective when the ball stud is aligned correctly with the rear stay-fold. You can check the horizontal position by ensuring the handlebar is parallel with the rear axle when in the locked position.

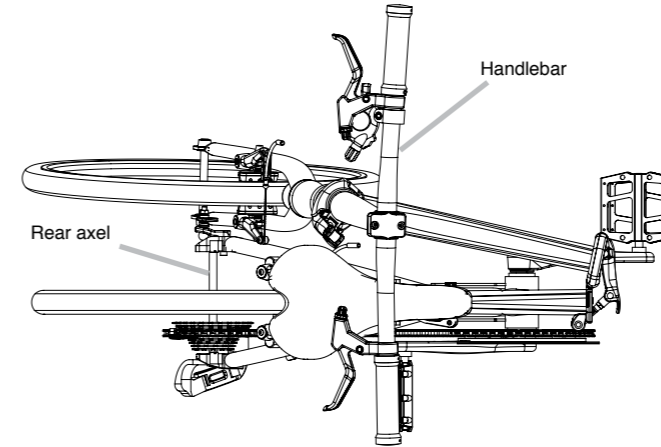

To adjust the horizontal position of the rear stay-fold catch, simply loosen the two M5 bolts with a 4mm Allen key and slide the stay-fold catch to the desired position. Remember to tighten the bolts back up once done.

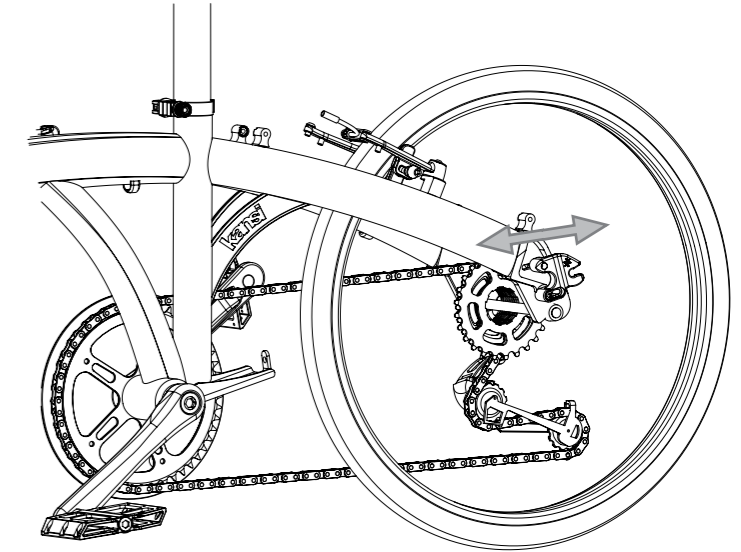

Rider safety information

Every effort has been made to ensure your Kansi frame and parts are the best they possibly can be. Please ensure that your Kansi is kept to its natural habitat - cycle lanes, roads and canal tow paths are best. Any other kind of riding other than this could result in premature wear, damage and possible failure. As nice as it would be, your Kansi is not a mountain bike...“we’re very sorry”.

Please take time to frequently inspect your bike. Brakes and steering are essential to your safety and giving them a quick check over before every ride is a good habit to get into.

General Road Usage

Kansi encourages riders to respect and be courteous to other road users and abide by cycling laws and regulations. Regulations about bicycle lighting, licensing of bicycles, riding on pavements, jumping red lights, riding while on a phone, riding under the influence of drugs or alcohol, helmet laws, and special bicycle traffic laws should always be adhered to. It’s your responsibility to know and obey your country’s individual rules and regulations. Correct cycling practices improve the image of cycling and cyclists, and we think this can only be a good thing. Swearing and shouting is not always the best way to alert people to your whereabouts. Bikes have bells for a reason, so let’s make sure drivers get used to hearing them.

At Kansi we like to encourage the use of a helmet and lights at all times. This is for your safety and for the safety of other cyclists around you. Try your local Kansi dealer for advice when making these essential purchases.

Tyres

Remember to check the condition of your tyres and the tyre pressures regularly. Low tyre pressures can result in longer commuting times and more of your energy being used over a given distance. Soft tyres are also more likely to puncture and perish, and a lack of air can make it easier for potholes and kerbs to damage your rim! We recommend your tyres are inflated to the maximum pressure shown on the sidewall of the tyre. More advice is available online at www.kansi.co.uk

Rider Weights

Kansi bikes are designed to be lightweight, simple and fun to ride. To ensure your Kansi can deliver all these things, we strongly recommend you observe the following weight guidelines. The bicycle should only be loaded with a pair of small/medium sized panniers. Over loading your bike may make it feel sloppy and a bit of a handful to manoeuvre. We at Kansi advocate that a total weight of 16 stone (101kg), which includes rider and luggage is not exceeded. Likewise, being 14 stone (89kg) and carrying a full military back pack is also not advisable. Loading above this limit would lead to premature wear of parts and in the long term could lead to structural failure.

Rider safety information (continued)

Chain Tension

If you have a Kanshi model equipped with derailleur gears (such as the Kanshi 9twenty) the chain tension will not require adjustment. However, if you have the single speed or hub geared models e.g 1twenty or 3twenty, there should be approximately 10mm to 12mm of vertical 'up and down' movement at the central point of the chain.

To correctly tension the chain, the rear axle nuts must be loosened and the wheel either gently pulled rearwards to increase chain tension or eased slightly forward to decrease it. It is essential that after correctly tensioning the chain, the rear wheel runs centrally through the rear chain stays. In order to re-tighten the rear axle nuts and keep the wheel central, the wheel should be gripped with one hand in the area where it passes through the chain stays, and the axle nuts gradually and evenly tightened.

Brake Blocks

Periodic checks should be made on all brake blocks, and if they are damaged or worn they must be replaced.

Your Kanshi brake blocks have small grooves running vertically through their braking surface and when these have almost worn away i.e. their depth is 0.5mm or less, the brake blocks must be replaced.

It is essential when brake blocks are replaced, that only genuine replacements of the correct type are used. Please ask your authorised Kanshi dealer for these.

Brake Adjustment

During use, not only do the brake blocks gradually wear down, but a small amount of inner brake cable stretch will occur. As a result of this, the distance the brake lever has to travel towards the handlebar grip to obtain an effective brake, will increase. To be efficient, your Kanshi brakes should work with the minimum of lever movement and when correctly adjusted, there should be a gap of approximately 1.5mm between each brake block face and the wheel rim.

Small brake block adjustments can be simply and quickly made using the cable adjusters fitted to both the front and rear brake levers. By unscrewing the adjuster (turning the barrel anti-clockwise), the brake blocks will move closer to the rim. After adjustment the lock-ring must be securely positioned against the body of the brake lever, to prevent further movement occurring. It is most important that at least 5 threads of the adjuster remain within the brake lever.

If this adjustment is not sufficient to correctly position the blocks near the rim, the barrel adjusters should be screwed back into the lever, and the excess inner cable pulled through the brake arm pinch bolt. Using the forefinger and thumb of one hand, hold the brake blocks against the rim and then slacken the pinch bolt using a 5mm Allen key. Carefully pull the inner cable through the pinch bolt and re-tighten the bolt.

Important: Always check the security of brake fixings and the operation of the brake after any adjustment is made.

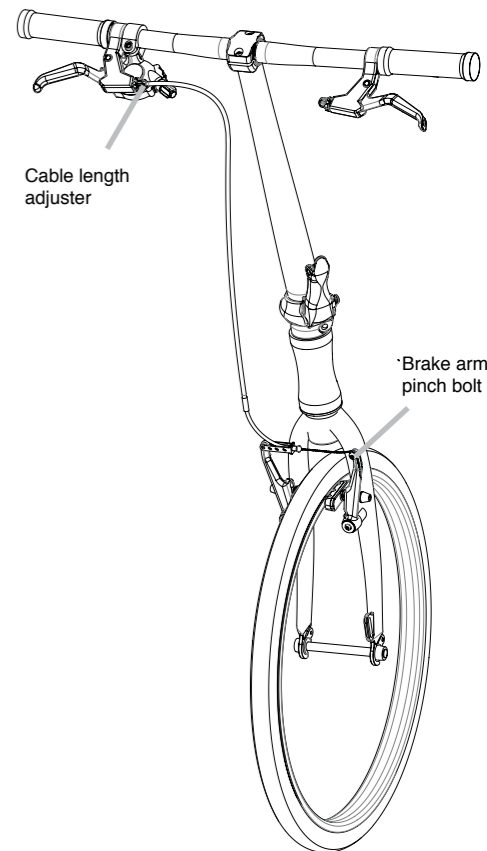

Rider safety information (continued)

Using Gears

If your Kansi is equipped with derailleur gears (such as the Kansi 9twenty), these will be operated by a lever positioned on the right hand side of the handlebar. With derailleur gears, changing gears must be carried out when the bicycle is being pedalled, but with an internal or hub gear system (such as the Kansi 3twenty), gear changing can be carried out at any time – whilst pedalling, freewheeling or even when the bicycle is stationary.

The purpose of gears, whether derailleur or internal, is to maximize pedalling efficiency. For the majority of people the optimum pedalling rate is in the region of 80 rpm, i.e. 80 revolutions of the cranks a minute. Whilst this may appear fast to some, it is the acknowledged rate that is best for the ‘human engine’ i.e. you the rider.

Use a high gear on flat roads or for riding downhill, and a low gear for uphill gradients. The correct use of your Kansi gear system will enable you to maintain your optimum pedalling rate.

Gear Adjustment

Together with this Owners Manual, your Kansi will come with detailed instructions relating specifically to the type of gear system fitted to your bicycle. Not only does this have information on the actual operation of the gears, but will also cover any in-service adjustments that may be required. Like this Owners Manual, these gear instructions should be kept safe for future reference.

Replacement Parts

Depending on how hard and how frequently your Kansi is ridden, various parts will wear and will therefore require replacing. It is most important to use correct and compatible parts to ensure your safety. We recommend that replacement tyres, inner tubes and brake blocks are purchased from your Kansi dealer, to ensure they are the correct size and type for your bicycle.

Many parts of your Kansi are safety critical ones, such as the frame, forks, handlebar, handlebar stem, seat post, cranks, pedals, wheel rims, chain, brake levers, brake cables and brake blocks. For these components we recommend only genuine replacement parts are used. If you are not confident about what size or type of component you require as a replacement, seek advice from your authorised Kansi dealer.

WARNING: Failure to confirm compatibility, properly install, correctly operate and maintain any component or accessory can result in serious injury. Changing the components on your bike with anything other than genuine replacement parts may compromise the safety of your bicycle and may void the warranty. Check with your authorised Kansi dealer before changing the components on your bike. As with all mechanical components, your Kansi is subject to wear and high stresses. Different materials and components have varying life spans. Be aware of this, as if the design life of a component has been exceeded, it may suddenly fail, possibly causing injuries to the rider. Any form of crack, scratches or change of colouring in highly stressed areas, may indicate the life of the component has been reached and should be replaced. Keep to regular service intervals and bear in mind that high usage and poor maintenance will lead to a shorter life expectancy, of your Kansi and its components.

Maintenance guide

After riding for a long period of time, road vibration may cause some parts to loosen, this is normal. It's important to make sure that adjustments are made as soon as these are detected. If you are unsure of any of the procedures outlined below, please see your authorised Kansi dealer for advice.

Kansi maintenance tips:

- Front / rear hubs, bottom brackets and headsets.** All use grease and are designed to be serviced when needed, with all grease being removed. The moving parts should be cleaned and should then be checked for wear. The bearing grease should then be replaced.
- Chains** need degreasing and lubricating with a light oil at regular intervals. Please don't add lube to a dirty chain. It's a waste of fresh lube and once it picks up grit and grime, the chain will wear out quicker. Additionally please refrain from using grease on chains (or cooking oil, save that for the stir fry!).
- Levers, handlebar stem and frame hinge** will need some TLC from time to time. This is normal, as they too are moving parts. We advise the use of Teflon based lubes on any contact part. This only needs to be done annually, but can help to extend the life of the hinge (your Kansi dealer is the expert on this!).
- Check tyre pressures regularly.** Also ensure you check brake pads, bolts and spoke tension regularly.
- Ensure that your **seat post** never exceeds its limit line, which is clearly marked on the post itself. Failure to do this could result in premature wear to the frame / seat post or possible malfunction.
- Your Kansi dealer should **service** your bike regularly. Just like a car your Kansi needs servicing to keep its warranty valid. Keeping your bike well maintained will also avoid any large service bills.
- When replacing parts, we advise you try and replace like for like (we worked really hard to ensure the spec of your Kansi was just right). This will also keep your Kansi feeling just how you like it.

Key

- A** - Adjust
- R** - Replace
- C** - Check
- L** - Lubricate
- T** - Tighten

Check item	Monthly	Half Year	1 year	2 years	2+ years
1. Check handlebar stem and bolts	<i>T</i>	<i>CL</i>	<i>CL</i>	<i>CL</i>	<i>CL</i>
2. Check pedals and bottom bracket	<i>T</i>	<i>CL</i>	<i>CL</i>	<i>CL</i>	<i>CL</i>
3. Check tyre pressure and tyre sidewalls	<i>C</i>	<i>C</i>	<i>R</i>	<i>C</i>	<i>R</i>
4. Check both front and rear hubs	<i>C</i>	<i>CL</i>	<i>CL</i>	<i>CL</i>	<i>CL</i>
5. Check chain for wear	<i>CL</i>	<i>C</i>	<i>C</i>	<i>C</i>	<i>C</i>
6. Check brake and pads	<i>C</i>	<i>C</i>	<i>C</i>	<i>C</i>	<i>C</i>
7. Check brake levers and cables		<i>AC</i>	<i>AC</i>	<i>AR</i>	<i>AR</i>
8. Check Brake shoes		<i>CR</i>	<i>CR</i>	<i>CR</i>	<i>CR</i>
9. Check chainset for wear		<i>C</i>	<i>C</i>	<i>C</i>	<i>C</i>
10. Check pedals and axles		<i>C</i>	<i>C</i>	<i>C</i>	<i>C</i>
11. Check spoke tension	<i>C</i>	<i>C</i>	<i>C</i>	<i>C</i>	<i>C</i>
12. Check mudguard and rack fittings		<i>C</i>	<i>C</i>	<i>C</i>	<i>C</i>
13. Check bell	<i>C</i>	<i>C</i>	<i>C</i>	<i>C</i>	<i>C</i>
14. Check frame and fork for damage/wear			<i>C</i>	<i>C</i>	<i>C</i>
15. Check frame and handlebar post hinges	<i>CA</i>	<i>CTA</i>	<i>CTAL</i>	<i>CTA</i>	<i>CTAL</i>
16. Check contact points for wear e.g saddle and grips		<i>C</i>	<i>C</i>	<i>C</i>	<i>CR</i>
17. Check all Allen key fittings	<i>CA</i>	<i>CA</i>	<i>CA</i>	<i>CA</i>	<i>CAR</i>
18. Check angle of handlebar post		<i>CA</i>	<i>CA</i>	<i>CA</i>	<i>CA</i>

This information is purely advisory and will be covered by your local Kansi dealer when your Kansi is booked in for a service or check up. More service information and videos are listed at www.kansi.co.uk

Kansi settings

Please use this table as a guide. Please ensure you have a fully functional calibrated torque wrench when adjusting any of the below settings.

Name of screw and nut	Metric Measure	Imperial measure
Front hub axle nut / quick release	<i>27.4 Nm</i>	<i>243 lb/in²</i>
Rear hub axle nut / quick release	<i>29.4 Nm</i>	<i>260 lb/in²</i>
Pedals axle	<i>34.3 Nm</i>	<i>303 lb/in²</i>
Handlebar fasten screw	<i>12.7 Nm</i>	<i>112 lb/in²</i>
Handlebar stem Allen key	<i>29.4 Nm</i>	<i>260 lb/in²</i>
Seat post clamp nut / quick release	<i>24.5 Nm</i>	<i>217 lb/in²</i>
Saddle clamp Allen key	<i>18.1 Nm</i>	<i>160 lb/in²</i>
Brake Allen key bolt	<i>7.8 Nm</i>	<i>70 lb/in²</i>
Chainset/BB axle nut	<i>34.3 Nm</i>	<i>304 lb/in²</i>
Reflector fastening screws	<i>1.8 Nm</i>	<i>13 lb/in²</i>

Warranty information

Kansi operates a simple and clear warranty period and process. Your Kansi bicycle is covered by a **2 year warranty** commencing from the date of purchase, (which can be **extended to 3 years for free** by registering at www.kansi.co.uk)

Within this warranty period, Kansi warrants each new Kansi bicycle to be free from any material defects in design, material and workmanship.

This warranty does not cover normal wear and tear, corrosion to the frame or any part or accessory due to the weather, improper assembly, misuse, accidental or wilful damage, negligence, poor maintenance, faulty adjustment or any modification, repair or replacement other than by an authorised Kansi dealer.

This warranty is only valid within the UK

You will be asked to submit a copy of your original receipt, so please keep this somewhere safe (we keep ours with our Kansi passport).

This warranty only covers the original purchase of the Kansi bicycle. Subsequent owners will not be entitled to a full warranty.

Should a warranty claim become necessary you should take your bicycle to your local Kansi dealer as soon as reasonably possible. After having had the opportunity to inspect the Kansi, the Kansi dealer or the factory shall, at its option, repair or replace the bicycle or the defective parts (as Kansi deems necessary), or refund the price of the defective parts or bicycle (as Kansi deems necessary) in full.

We will try and solve any disagreements quickly and efficiently. If you are not happy with the way we deal with any disagreement and you want to take court proceedings, you must do so in England or Wales.

Information on your nearest dealer can be found at www.kansi.co.uk. You can also find full documentation and technical documents there too.

You will also have statutory rights in relation to your Kansi bicycle and nothing in this brochure will reduce your statutory rights relating to your Kansi bicycle. For further information about your statutory rights contact your local authority Trading Standards Department or Citizens Advice Bureau.

Additional components and accessories

There are many components and accessories available to enhance the comfort, speed, weight and appearance of your Kansi.

Before installing any component or accessory make sure that it is compatible with your Kansi, by checking with your nearest Kansi dealer. Kansi bikes come with a great selection of components and as such, we recommend the use of Kansi components and accessories, fitted by an authorised Kansi dealer.

If you install any non-Kansi components or accessories or Kansi components or accessories in a manner which is not recommended by Kansi then these will not be subject to the original Kansi warranty.

Warranty in the UK is provided by Fisher Outdoor Leisure limited



Fisher Outdoor Leisure
Units 8 -9 Brick Knoll Park
Ashley road
St Albans
Hertfordshire
AL1 5UG

Tel: 01727 798 347/357
Email: warranty@fisheroutdoor.co.uk
Web: www.fisheroutdoor.co.uk

Contact info

Kansi can be found on the web at www.kansi.co.uk

Keep in touch to find out about new products, sample giveaways and details of events we will be attending over the forthcoming year.

Tel: 01727 798 345

Email: info@kansi.co.uk

Web: www.kansi.co.uk

Postal enquires can be sent to:

Kansi

c/o Fisher Outdoor Leisure

Units 8-9 Brick Knoll Park

Ashley Road

St Albans

Hertfordshire

AL1 5UG

United Kingdom

